

New UL 1971, Constant Flash Rate, Low Current

Meets Code Requirements for Supervised Systems

The GX Series are high quality remote signaling devices that offer both audible alarms, visual alarms, or a combination of both.

The GX Series are available in Fire Alarm Red or Off-White faceplates with a textured grain finish. These plastic faceplates permit attractive flush mounting.

The GX Series with the 15/75, 30/75 and 110-1cd models meet or exceed the re-

quirements of 4.28.3 of the ADA. All models are listed for both filtered and unfiltered power.

The GXS Series and GX90S Series, at 12 and 24VDC have minimal peak operating current and only a momentary start-up current, while the 1 Hz flash rate appliances have a minimal peak operating current normally less than a 17 percent increase from nominal operating current and minimal start-up current.



GX-90
Remote Audible Signal

Available Models

Model Number	Nominal Voltage	Light Intensity In Candela	Combined Rated Current Draw @ Nominal Voltage	Combined Rated Current Draw @ Maximum Voltage	Flash Rate/Min.	Peak dB @10 Ft.
GX90-2 *	12 VDC	—	12mA	12mA		90
GX90-4 *	24 VDC	—	15mA	18mA		90
GXS-2-15-1 **	12 VDC	15	113mA	113mA	60	—
GXS-2-15/75 **	12 VDC	15 (UL 1971) 75 (UL 1638)	209mA	240mA	60	—
GXS-4-15-1 *	24 VDC	15	78mA	69mA	60	—
GXS-4-15/75-W **	24 VDC	15 (UL 1971) 75 (UL 1638)	105mA	87mA	60	—
GXS-4-30/75-W	24 VDC	30 (UL 1971) 75 (UL 1638)	142mA	114mA	60	—
GXS-4-15/75-C **	24 VDC	15 (UL 1971) 75 (UL 1638)	120mA	100mA	60	—
GXS-4-110-1 **	24 VDC	110	220mA	179mA	60	—
GXS-120-177 **	120 VAC	177	400mA	—	60	—
GX90S-2-15-1 *	12 VDC	15	125mA	96mA	60	90
GX90S-2-15/75 *	12 VDC	15 (UL 1971) 75 (UL 1638)	219mA	228mA	60	90
GX90S-4-15-1 *	24 VDC	15	93mA	87mA	60	90
GX90S-4-15/75-W*	24 VDC	15 (UL 1971) 75 (UL 1638)	120mA	105mA	60	90
GX90S-4-30/75W*	24 VDC	30 (UL 1971) 75 (UL 1638)	157mA	132mA	60	90
GX90S-4-15/75-C*	24 VDC	15 (UL 1971) 75 (UL 1638)	135mA	118mA	60	90
GX90S-4-110-1 *	24 VDC	110	235mA	197mA	60	90

Note: All 24 VDC models operate from 21-30 VDC -20 + 10%
All 12 VDC models operate from 10-16 VDC

24VDC 15 candela units have a start-up current of 114mA and a peak operating current of 84mA
15/75 candela units have a start-up current of 130mA (wall) and a peak operating current of 110mA
15/75 candela units have a start-up current of 140mA (ceiling) and a peak operating current of 125mA
30/75 candela units have a start-up current of 120mA and a peak operating current of 160mA
110 candela units have a start-up current of 148mA and a peak operating current of 240mA



GXS
Remote Visual Signal with
Universal Mounting Plate



GX-90S
Remote Audible/Visual
Signal

Approvals



This symbol on the product's nameplate means it is Listed by UNDERWRITERS LABORATORIES, INC.

- Americans with Disabilities Act (ADA 4.28.3)
- BFP (City of Chicago)
- BS+A/MEA #285-91-E
- CSFM *Listing 7135-569:113
**Listing 7125-569:114
- UL 464, UL 1971, UL 1638
- ULC

WHEN PLACING AN ORDER: add the following to the end of the model number:

"W" = Wall mount and "R" = Red faceplate
"P" = Plain (no lettering) "W" = Off-White faceplate
"C" = Ceiling mount (1575 models only)

Wiring Diagram GX-90

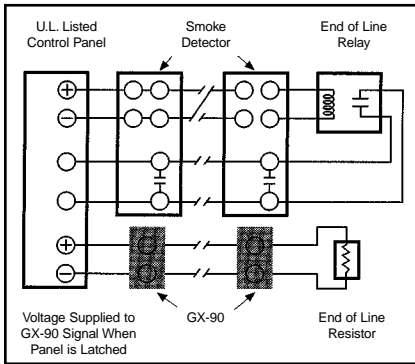

Wiring Diagram GX90S & GXS

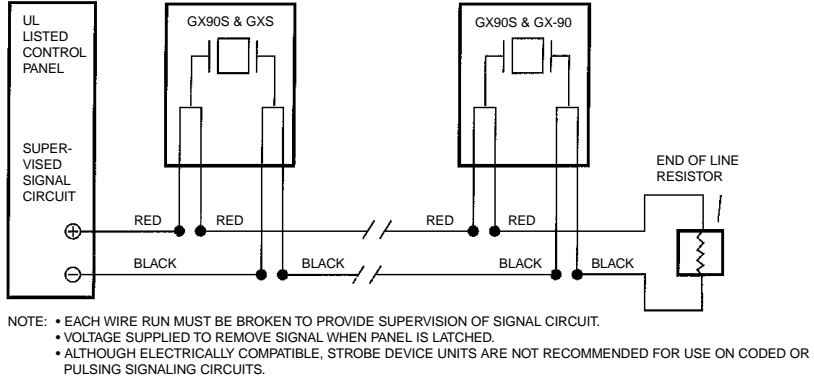

Mounting

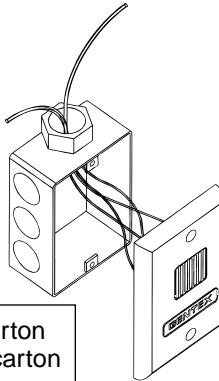

24 units per carton
5 pounds per carton

Mounting Rough-in Box and Run Wiring

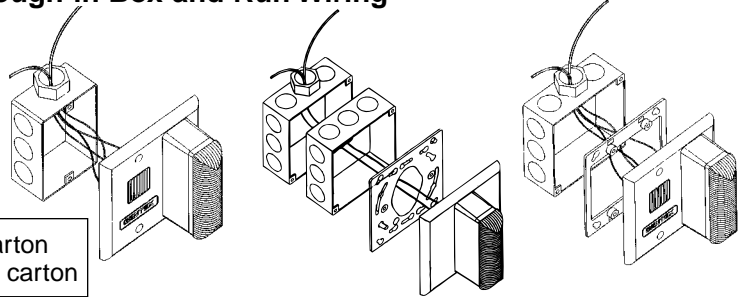

24 units per carton
12 pounds per carton

24 units per carton
12 pounds per carton

Dimensions GX-90

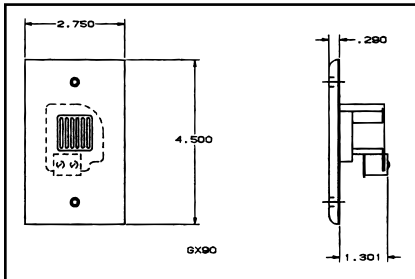

Dimensions GX90S

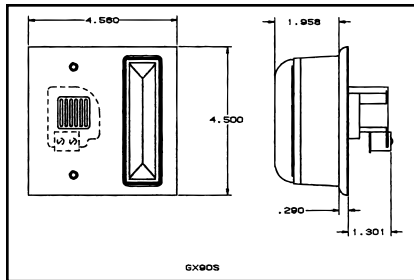

Dimensions GXS

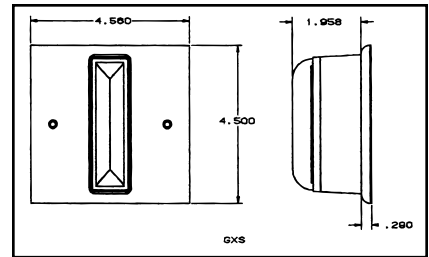

Architect & Engineering Specifications

The alarm horns shall be Gentex Model No. GX-90. The appliance shall be listed with Underwriters Laboratories for use with Fire Protective Signaling Systems and produce a minimum 85 dB at 10 ft. The appliance shall be of solid-state construction and be polarized to operate from 21-30 VDC with a 15 milliamp current drain at 24 VDC; and from 12 VDC with a 12 milliamp current drain. The appliance shall be provided with 2 terminals, and a mount to a variety of single-gang back boxes.

Architect & Engineering Specifications

The audible or audible/visual shall be Gentex model GX90S or approved equal, and shall be listed by Underwriters Laboratories per UL464, and when combined with the strobe option the strobe shall be listed per UL 1971. The notification appliance shall also be listed with the California State Fire Marshall (CSFM) and the Bureau of Standards and Appeals (NYC).

The notification appliance shall produce a peak sound output of 90dB(A) or greater as measured in an anechoic chamber.

The maximum current consumption at 24 VDC for the audible only shall not exceed 15 milliamps at 24 VDC and 12 milliamps at 12 VDC, and the maximum current consumption for the combination audible/visual notification appliance when utilizing a 15cd strobe shall not exceed 93 milliamps at 24 VDC and 127 milliamps at 12 VDC.

For those applications requiring a higher output in light intensity, the maximum current consumption at 24 VDC shall not exceed the combined current consumption of audible with the following visual with each candela: 15/75cd shall not exceed 120 milliamps, 30/75cd shall not exceed 157 milliamps, 110cd shall not exceed 235 milliamps.

The visual signal shall have a 1 Hz flash rate regardless of input voltage.

The notification appliance shall be provided with terminals and be capable of mounting to a 4" square box or a single gang switch box.

Architect & Engineering Specifications

The visual signal shall be the Gentex Model GXS or approved equal. The visual appliance shall be listed by Underwriters Laboratories for use with fire protective signaling systems for the hearing impaired (UL 1971) and be UL-listed per UL 1638.

The visual appliance shall be installed in accordance with the appropriate provisions of the Uniform Building Code, National Fire Protection Association, American National Standards, Southern Building Codes, or other applicable state and local requirements.

The visual signal shall be capable of mounting to a single gang, double gang, double work box, or 4" square back box.

The visual signal shall have a voltage range of 21-30 VDC.

The visual signal shall have a constant flash rate of 1 Hz regardless of listed input voltage.

The visual signal shall not exceed the following current consumption's at 24 VDC: 78 milliamps at 15cd, 105 milliamps at 15/75cd, 142 milliamps at 30/75cd, and 220 milliamps at 110cd.